

BURLINGTON PULL HANDLES - FACE FIX

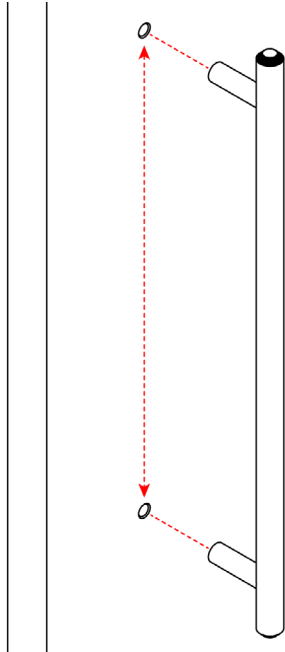

1. Drill holes to the appropriate size, in the position required and counter sink.

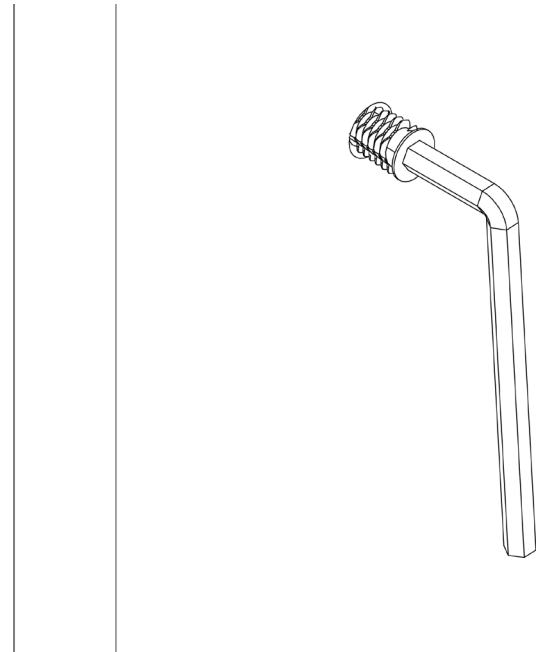

2. Push the wood screws into the newly drilled holes, and tighten with allen key until flush.

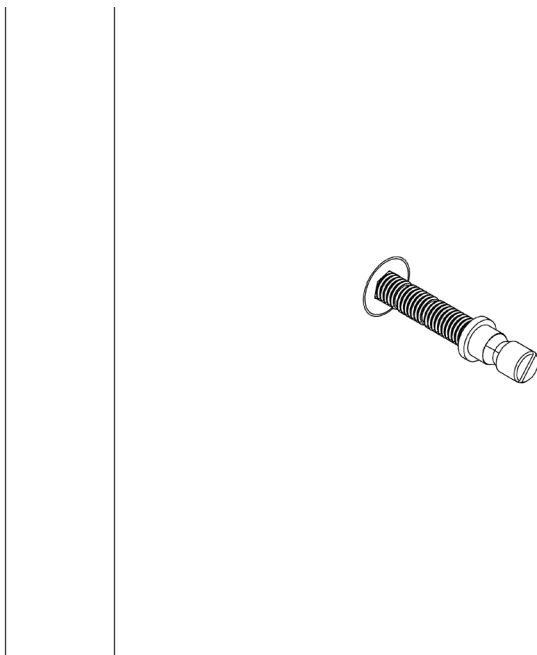

3. Insert the threaded end of the brass headed bolt into the wood screw and tighten until only the head is exposed. You may need to trim the bolt to size.

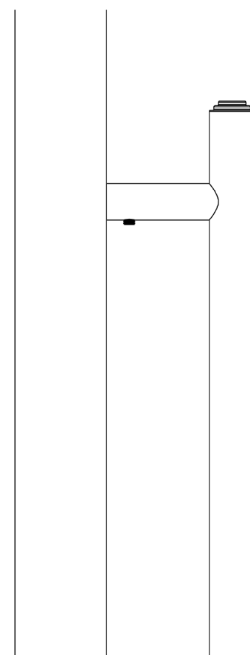

4. Place the pull handle over the brass head of the screw and tighten the grub screws top and bottom.

Note: When applying to a glass door, ensure white plastic sleeve is used

Face fix is only suitable for solid core doors. Do not drill through entire door.